

**Fixed Mount Applications** The following components are included for Fixed Mount Applications

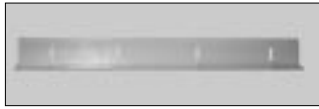

(4) Lexan mounting brackets (slotted)



(8) #10 x 3/4" Stainless Steel Mounting Screws

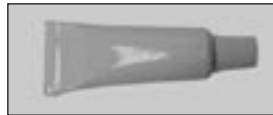

(1) 0.5 oz. Tube All-Weather Silicone Caulk

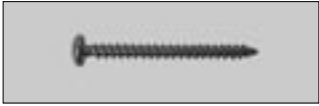

(8) #10 x 2" Stainless Steel Mounting Screws

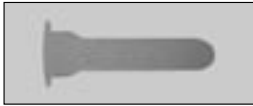

(8) Alligator Wall Anchors



1

**Locate lower bracket.**

Locate and position the mounting bracket next to the lower side of the window opening. The bracket is approximately 1" narrower than the shutter panel, which will leave 1/2" between window opening and the end of the mounting bracket. Using a level to verify that the mounting bracket is located correctly, mark the position of the two slots on the wall. The slots in the mounting bracket will allow for some minor adjustment in the vertical position.



5

**Drill 9/64" pilot holes into shutter for #10 x 3/4" screw.**

Place the shutter panel up against the wall in the desired position. The lower mounting bracket will support the weight, but be sure to stabilize the shutter panel so it does not tip off. Drill a 9/64" diameter pilot hole 1" in depth into the shutter panel through the pre-drilled hole located on the mounting bracket. Make sure to drill straight up into the shutter panel. Repeat this step to drill a second pilot hole through the pre-drilled bracket. Complete the pilot holes through the top mounting bracket.



2

**Drill 1/4" pilot hole and install anchor into wall.**

With the slots properly marked on the wall, drill a 1/4" diameter pilot hole 2" in depth at the desired location along the marked slots. In each of the 1/4" holes, place one of the alligator wall anchors. These anchors are suitable for mounting into concrete, aerated concrete, brick, masonry, stone, cinderblock, stucco and wood. Gently tap the head of the anchor until it is flush with the wall.

Anchor suitable for: Concrete, Aerated Concrete, Brick, Masonry, Stone, Cinderblock, Stucco, Wood

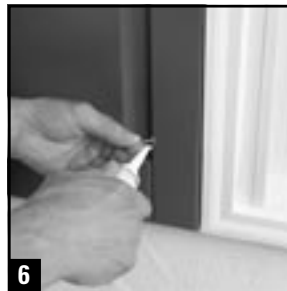

6

**Place silicone on threads of #10 x 3/4" screws.**

Take each of the 3/4" mounting screws and spread a bead of all-weather silicone caulk along the threads. This will provide a barrier between the mounting holes and the interior of the shutter panel.



3

**Secure bracket into wall at desired height with #10 x 2" screw.**

Place the bracket up against the wall and locate the anchors through the mounting slots. Drive the 2" screw through the slot and into the alligator wall anchor. The anchor will expand in the wall and is not capable of coming out. However, the anchor may be reused if adjustment of the screw depth is necessary during the initial installation. Repeat this step to drive a second screw through the second slot. Make sure the bracket and mounting screws are secure into the wall.



7

**Drive #10 x 3/4" screw into shutter.**

Drive the 3/4" mounting screw, with silicone on the threads, into the pre-drilled pilot hole until the screw is snug. Make sure not to overtighten the mounting screw, which may cause the material to strip out. Repeat this for each of the mounting screws, two per mounting bracket. The shutter panel is now properly mounted. Repeat steps 1-7 for the second shutter.



4

**Locate top bracket and repeat steps 2 & 3 to mount.**

Place the shutter on the lower bracket and stabilize so it cannot tip off. Take the second mounting bracket and locate the correct position at the top of the shutter panel by scribing a line to locate the height. Remove the shutter panel carefully. Place the bracket on the wall and mark the two slots in the desired location. Repeat steps #2 & #3 to complete the installation of the mounting bracket.



**You have successfully mounted a pair of shutters.**